

FOOTHILL SHOPPING CENTER

PHOENIX, ARIZONA

DRAWING PREPARED BY:
OSBORN & VANE ARCHITECTS INC.
 82008.79 5 MAR 2015

SITE PLAN
 SCALE
 0 50' 100' 150'



Sclay MANAGEMENT
 P.O. BOX 680024
 HOUSTON, TEXAS 77268
 (281) 537-9066

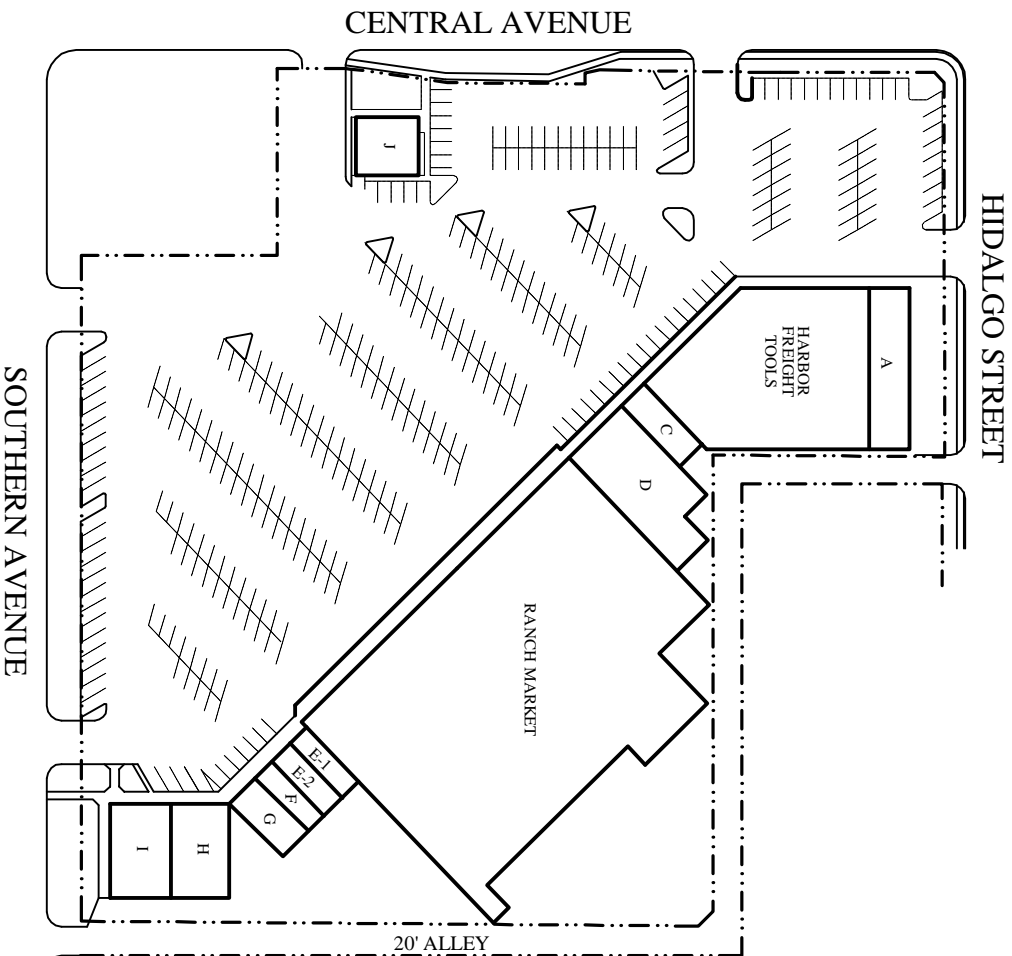

- NOTES:
1. PLAN DIMENSIONS AND STORE FRONTAGES LISTED ARE APPROXIMATE ONLY. AREAS SHOWN ARE ACTUAL PRESENT LEASABLE AREAS.
 2. PARKING SPACE LOCATION AND ACTUAL CAR COUNT IS REASONABLY ACCURATE BASED ON GIVEN DATA AND PER SITE SURVEY. THESE SPACES ARE SUBJECT TO CHANGE, HOWEVER, AND MUST CURRENT EXISTING CONDITIONS MAY NOT BE REFLECTED ON THIS DRAWING.
 3. MAJOR, OR ANCHOR, TENANTS EXIST AS OF DATE OF DRAWING, HOWEVER, THESE SPACES AND THEIR TENANTS ARE SUBJECT TO CHANGE.

STATISTICS

SPACE	AREA	FRONTAGE
RANCH MARKET	43,500 S.F.	421.0'
A	3,058 S.F.	55.0'
HARBOR FREIGHT TOOLS	14,010 S.F.	220.0'
C	1,288 S.F.	15.0'
D	5,261 S.F.	36.0'
E-1	825 S.F.	15.8'
E-2	925 S.F.	17.8'
F	780 S.F.	15.0'
G	1,456 S.F.	18.0'
H	2,600 S.F.	40.0'
I	2,700 S.F.	40.0'
J	1,710 S.F.	40.0'

TOTAL LEASE AREA : 78,113 S.F.
 TOTAL LAND AREA : 6,287 AC.
 BLDG./LAND RATIO : 28.5 %
 TOTAL PARKING : 333 CARS
 PARKING RATIO : 4.26 cars/1000